

Banquet Capacities and Set-up

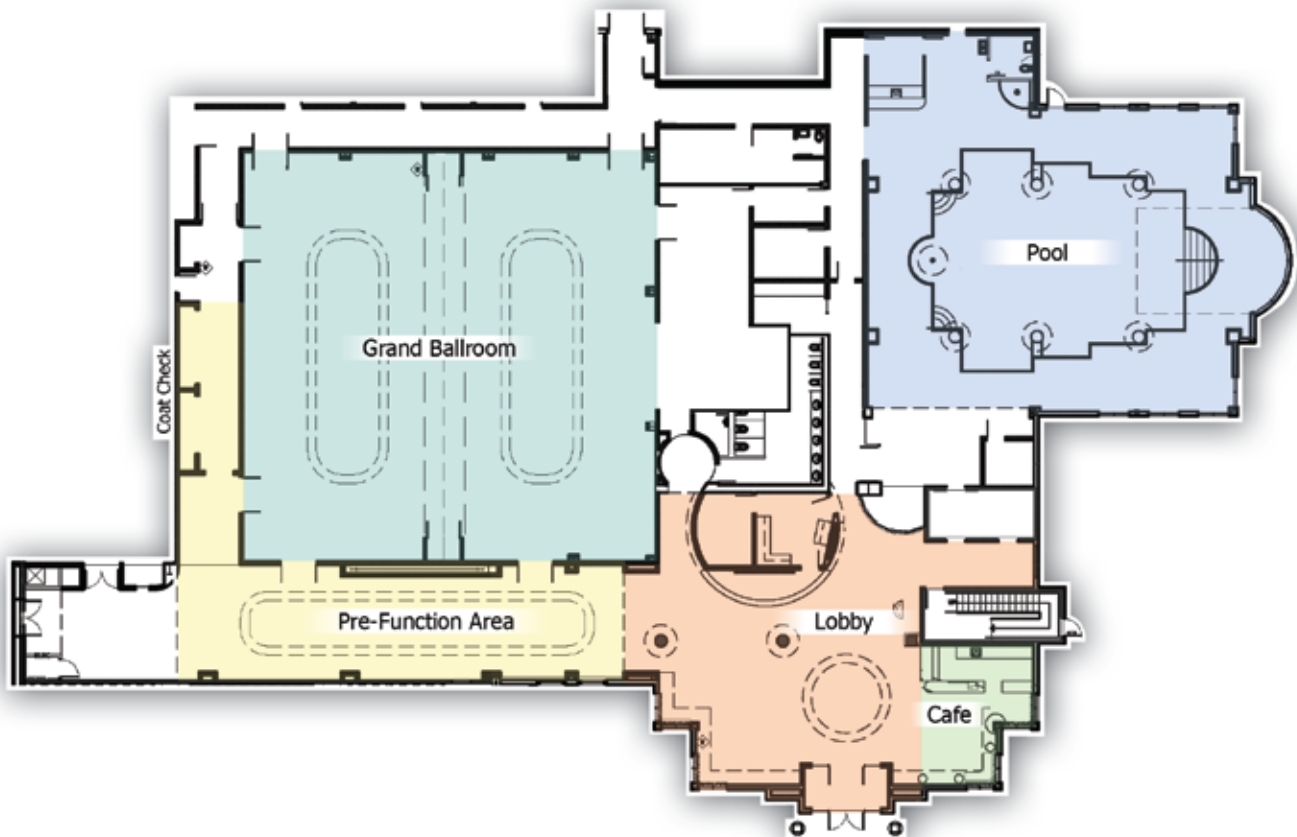

*W*hether your visit is for business or pleasure, action or relaxation, South Beach Casino & Resort will cater to your every desire. Located 30 minutes north of Winnipeg on Highway 59, near the shores of Lake Winnipeg, South Beach Casino & Resort is the perfect location for planning a meeting, conference, staff retreat, special event, or social function.

“Simply Irresistible” fun and excitement are only steps away through the promenade in the South Beach Casino which consists of 600 slot machines, live poker, Blackjack tables and top-notch live entertainment.

Our goal at South Beach Casino & Resort is to create the experience of an exclusive resort, traditionally bound in professionalism and integrity. We are committed to providing the highest standard of excellence in customer service and guest satisfaction.

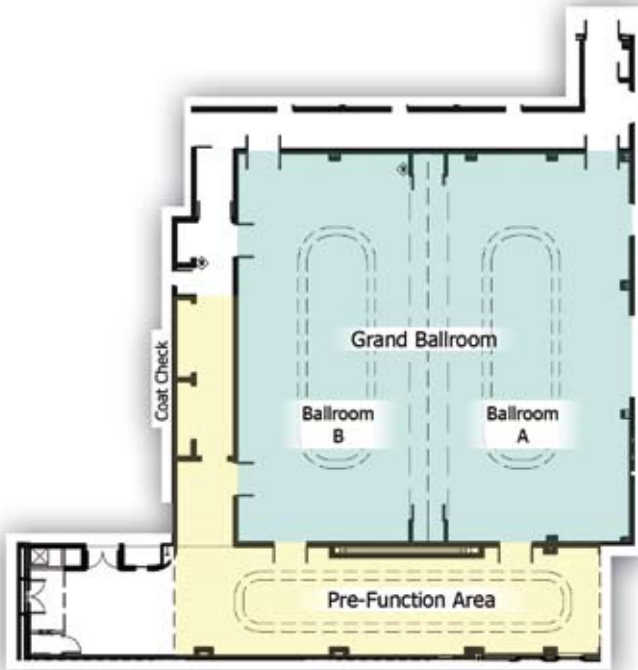

Feel welcomed in our lavish Grand Ballroom, offering 7000 square feet of separable and pillar less event space. Features include complimentary parking and valet services, wireless high-speed internet, technologically advanced in room audio equipment and Pre-function reception area.

We will take pleasure in the opportunity to customize menus, find the perfect entertainer or search out just the right décor. Let our European trained Executive Chef and his team of culinary professionals create a memorable event for you and your guests.

Our meticulous attention to detail and gracious staff will proudly extend to you and your guests the highest standard of excellence.



	Dimension and Square Footage	Ceiling Height	Reception Style	Round tables of 10 without Dance Floor	Round tables of 10 with 30' x 30' Dance Floor	Classroom style	Boardroom Style	Theatre Style
Grand Ballroom	71' x 70' 4970 ft ²	13.6'	500 people	380 people	300 people	200 people	44 people	440 people
Prefunction Area	100' x 20' 2000 ft ²	13.6'	200 people	150 people	x	x	x	x
Grand Ballroom "A"	71' x 35' 2485 ft ²	13.6'	250 people	160 people	150 people	152 people	44 people	283 people
Grand Ballroom "B"	71' x 35' 2485 ft ²	13.6'	250 people	160 people	150 people	152 people	44 people	283 people



It's Time to Stay, Play and Getaway

